

ASSEMBLY INSTRUCTION

Garden Cart

with Removable Folding Sides
(Easy Assembly)



1. Remove parts from carton. Place carton on flat surface and complete assembly on the carton to keep from scratching or damaging the finish of parts.

To assemble truck use socket wrench, an adjustable crescent wrench or the wrench provided in the hardware package.

Parts List

- A. Bed (1)
- B. Side Panels (2)
- C. Front Panel (1)
- D. Back Panel (1)
- E. Wheels (4)
- F. Front Axle Support (1)
- G. Rear Axle Support (1)
- H. U Yoke (1)
- I. Handle (1)

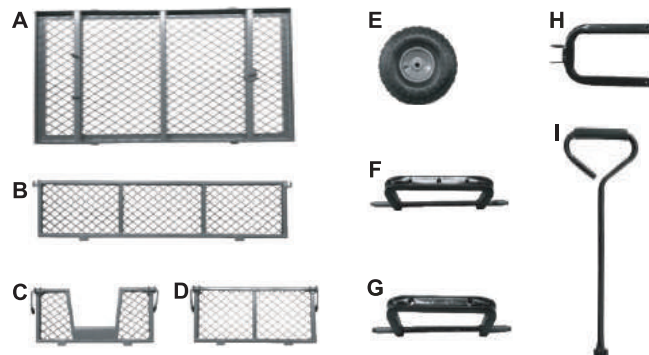

Hardware List

- A. M8 x 60 Flat Bolt (2)
- B. M8 x 60 Hex Bolts (1)
- C. M12 Nylon Nuts (7)
- D. M8 Nylon Nuts (3)
- E. M12 Flat Washers (7)
- F. M8 Flat Washers (3)
- G. Fence Assembly Pins (8)

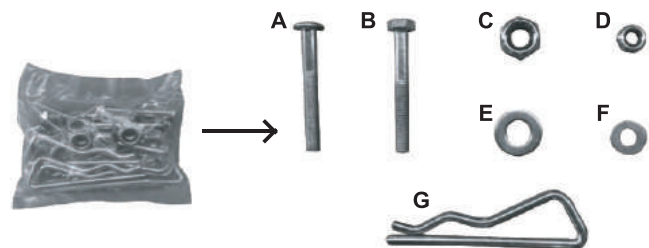

a. **IMPORTANT SAFETY INSTRUCTIONS**

- b. MAX LOAD: 550 lbs. NEVER OVERLOAD THIS CART
- c. DO NOT inflate tires more than 35 psi
- d. DO NOT operate if any part is damaged or broken
- e. Lower fence rails when loading large items onto cart
- f. Distribute load evenly in cart bed
- g. DO NOT use on steep inclines where tipping may occur
- h. Do not allow children to use this cart. It is not a toy
- i. It is recommended that you do not modify or use this cart for any application other than that for which it was designed
- j. MAINTENANCE
- k. When not in use, store the cart in a place which is dry and out of direct sunlight
- l. Periodically check tire pressure. The tire pressure should be set at 30 +/-2 PSI
- m. Periodically check hardware. Ret tighten if any hardware is loose

2. Turn truck Bed upside down.

Attach Rear Axle Support to rear of Bed using M12 Washers (E) and M12 Nylon Nuts (C).

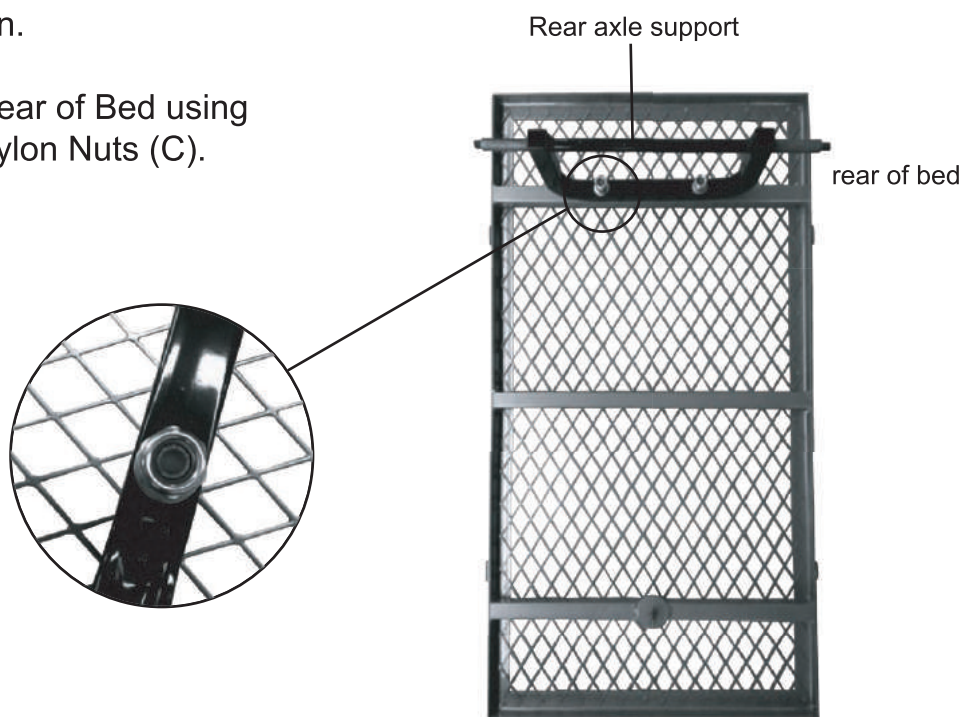

3. Attach U Yoke to Front Axle Support using M8 x 60 Flat Bolts (A), M8 Washers (F) and M8 Nylon Nuts (D).

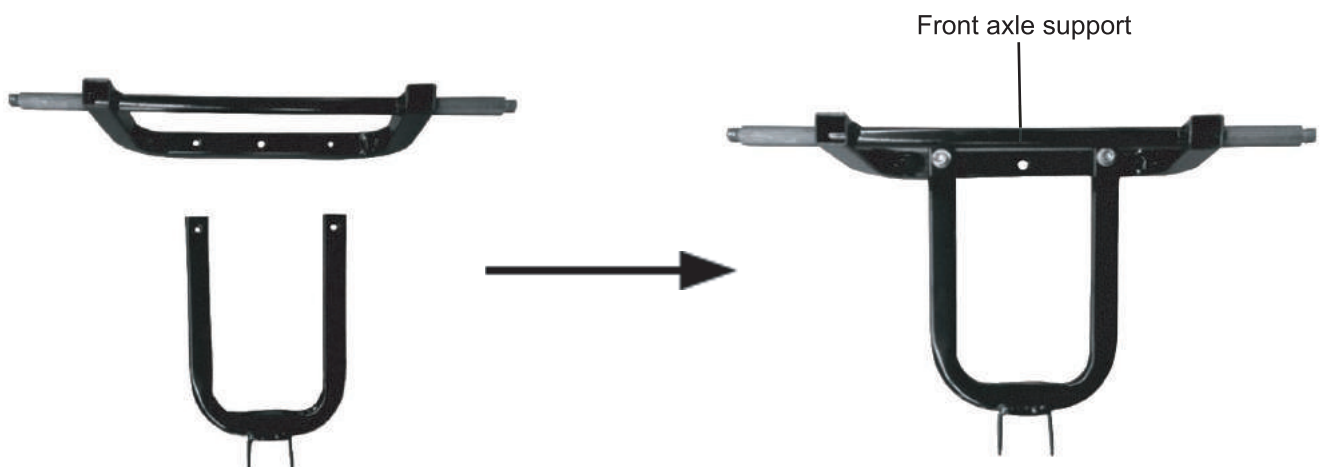

4. Attach the Assembled U Yoke & Front Axle Support to front of bed using M12 Washers (E) and M12 Nylon Nuts (C). Tighten bolt fully and then loosen one half turn for easier steering movement.

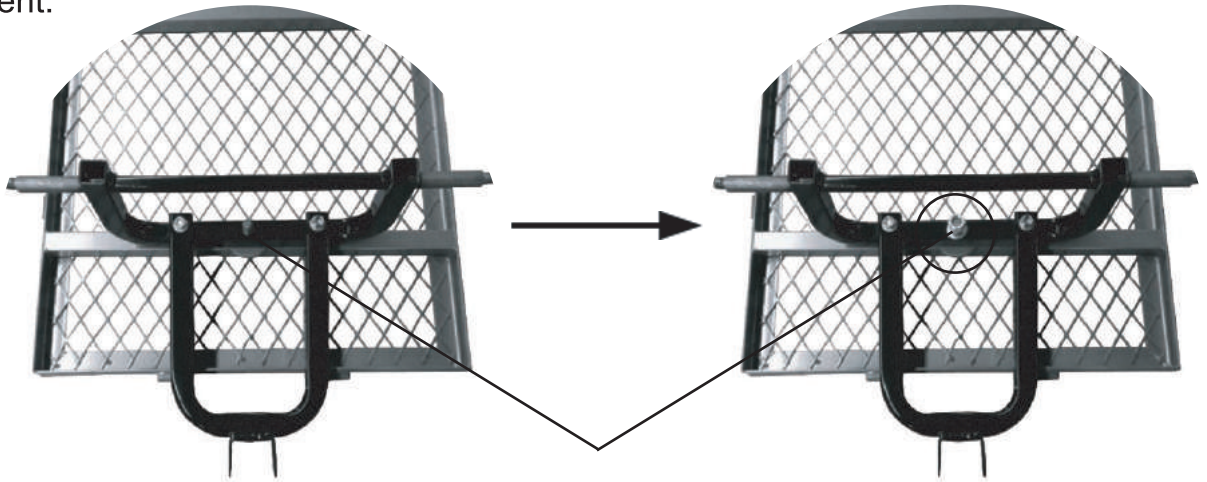

5. To attach the wheels, put wheel on to axle and secure with M12 Washer (E) and M12 Nylon Nut (C)

Complete step for all 4 wheels.

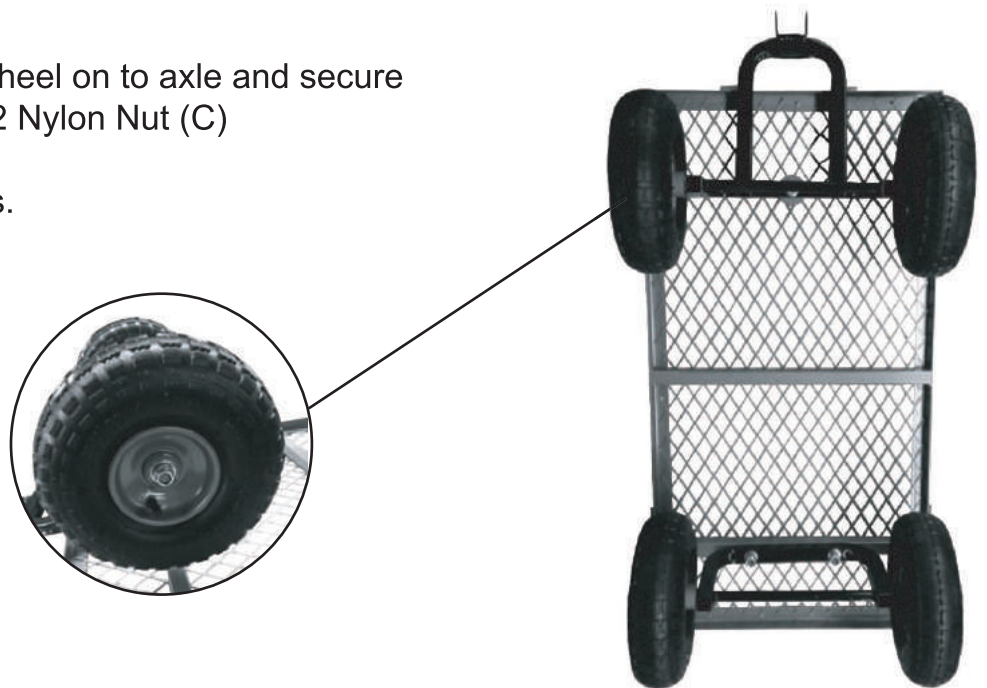

Turn truck over onto wheels.

6. Place end of Handle in front of U Yoke and secure to Yoke using the M8 x 60 Hex Bolt (B), M8 Washer (F) and M8 Nylon Nut (D).

Tighten bolt fully and then loose one half turn for easier Handle movement.

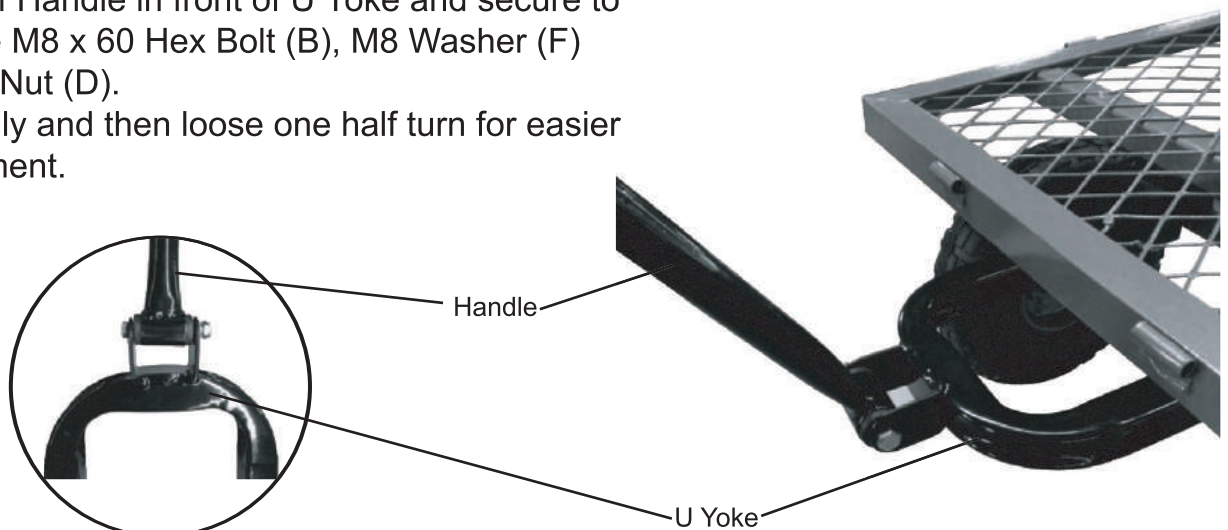

7. One at a time, attach the Side Panels by aligning the hinges, sliding Fence Assembly Pins (G).

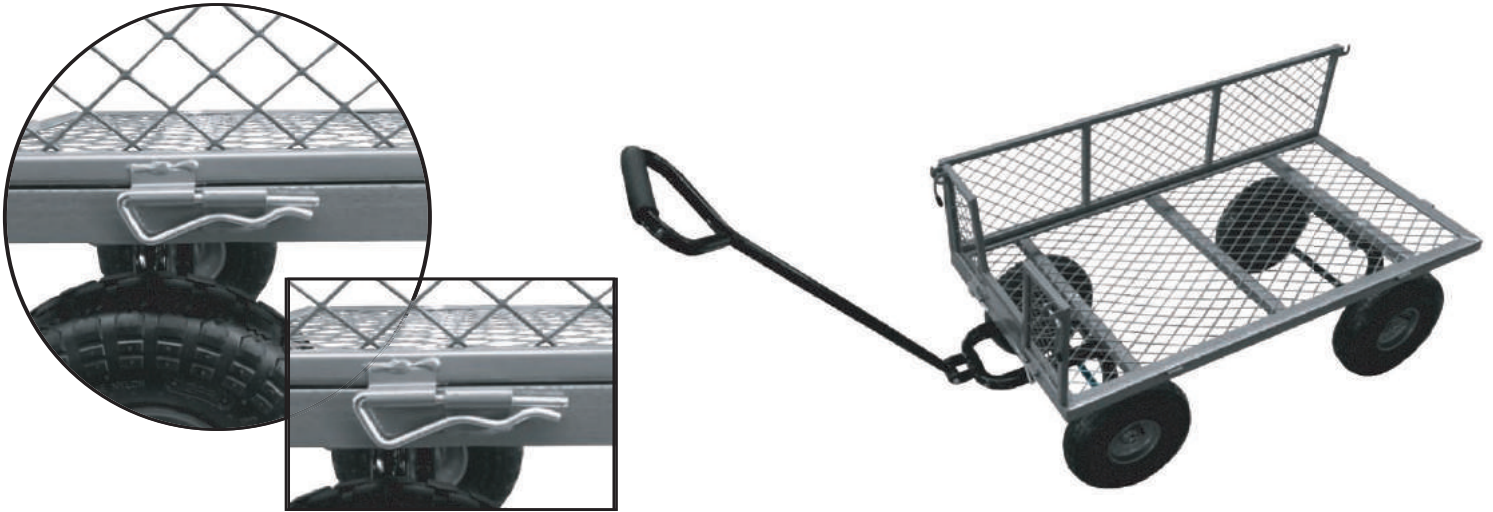

8. To lock the Sides in place, hold Side Panel in the up position. Rotate Side Panel Lock Lever from the up position to the down position and in doing so capture the Side Panel hook.

To fold truck sides down rotate the Side Panel Lock Levers into the up position and fold panels down.

